

VERTICAL CROSS SECTION
Typical for two or more units

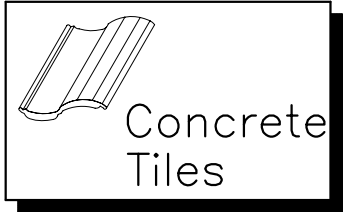
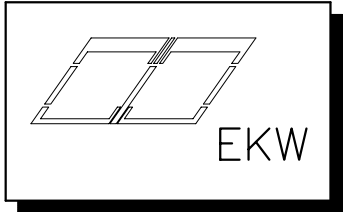
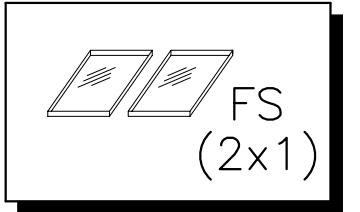
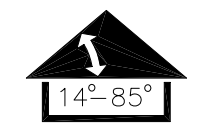

- VELUX EKW sill flashing
- Battens
- Tiles
- Underlayment
- Sheathing
- Insulation
- Finish material

Support Batten

Outside frame height

Vapor barrier

Blocking as required.
Insulate carefully
around skylight

- VELUX deck seal
- Tiles
- Battens

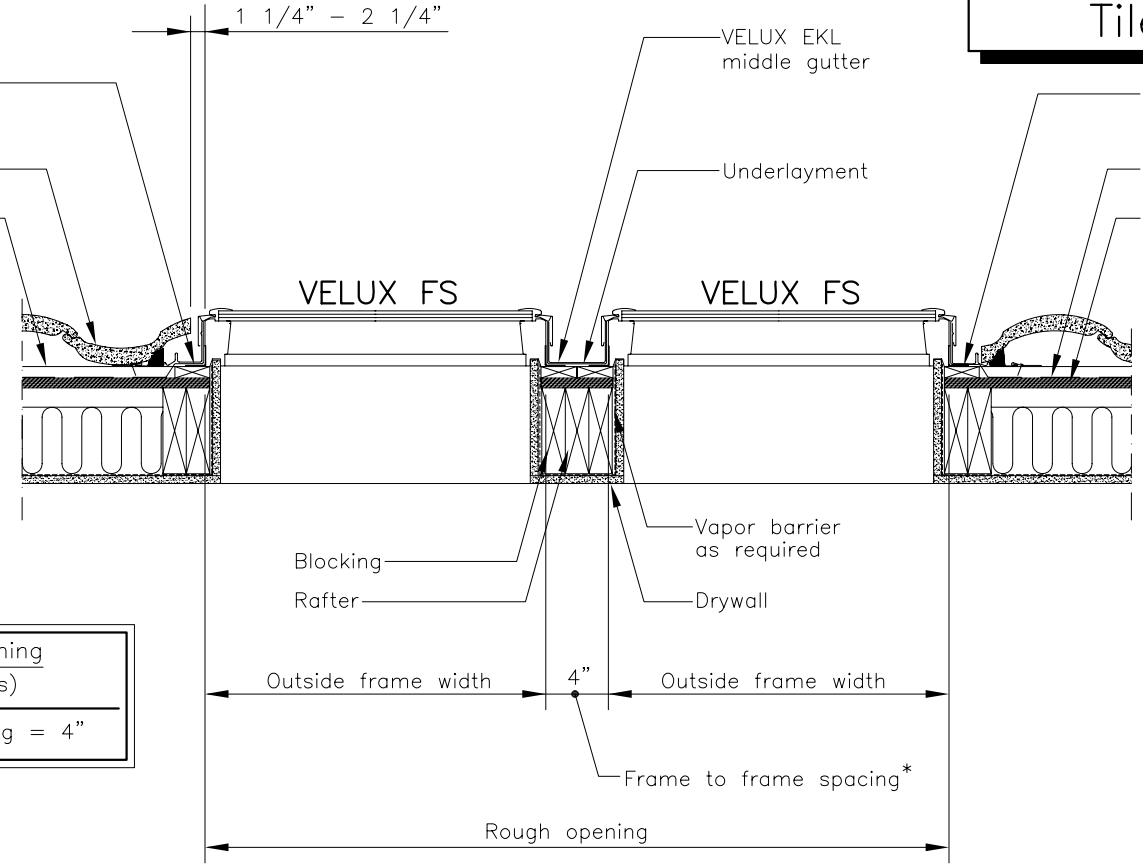

HORIZONTAL CROSS SECTION
Typical for two or more units

*Horizontal, side x side, Combi flashing
(frame to frame spacing requirements)
Minimum spacing = 4" / Maximum spacing = 4"

GENERAL NOTES

1. This drawing illustrates a general arrangement layout with recommendations for VELUX skylight installations in a structure with tile roofing. This drawing utilizes the VELUX FS model skylight.
2. The architectural/structural design and specifications of a skylight installation for tile roof applications are determined and provided by others. The design criteria includes (but is not limited to design loads, structural configurations) structural framing member sizes and material, architectural finishes and integration with the roofing system of the building. VELUX assumes no responsibility or liability in the design, construction and performance of a skylight installation by others.
3. Nail the flashing pieces to the frame – not the roof.
4. Underlayment to be folded up against all sides of skylight.
5. Vapor barrier should be used to avoid moisture.
6. Wrap skylight frames in underlayment provided with flashing.

This drawing is an instrument of service and is provided for informational use only.

	VELUX 1418 Evans Pond Road Greenwood, SC 29649 1-800-88-VELUX www.VELUXUSA.com		Name	Date
	Sky-Product Management	General Arrangement Layout of (2x1) VELUX FS Skylights / EKW Flashing	Drawn by Checked by Drawing No.	JDH WQ EKW01-0410