

**ELEVATION**

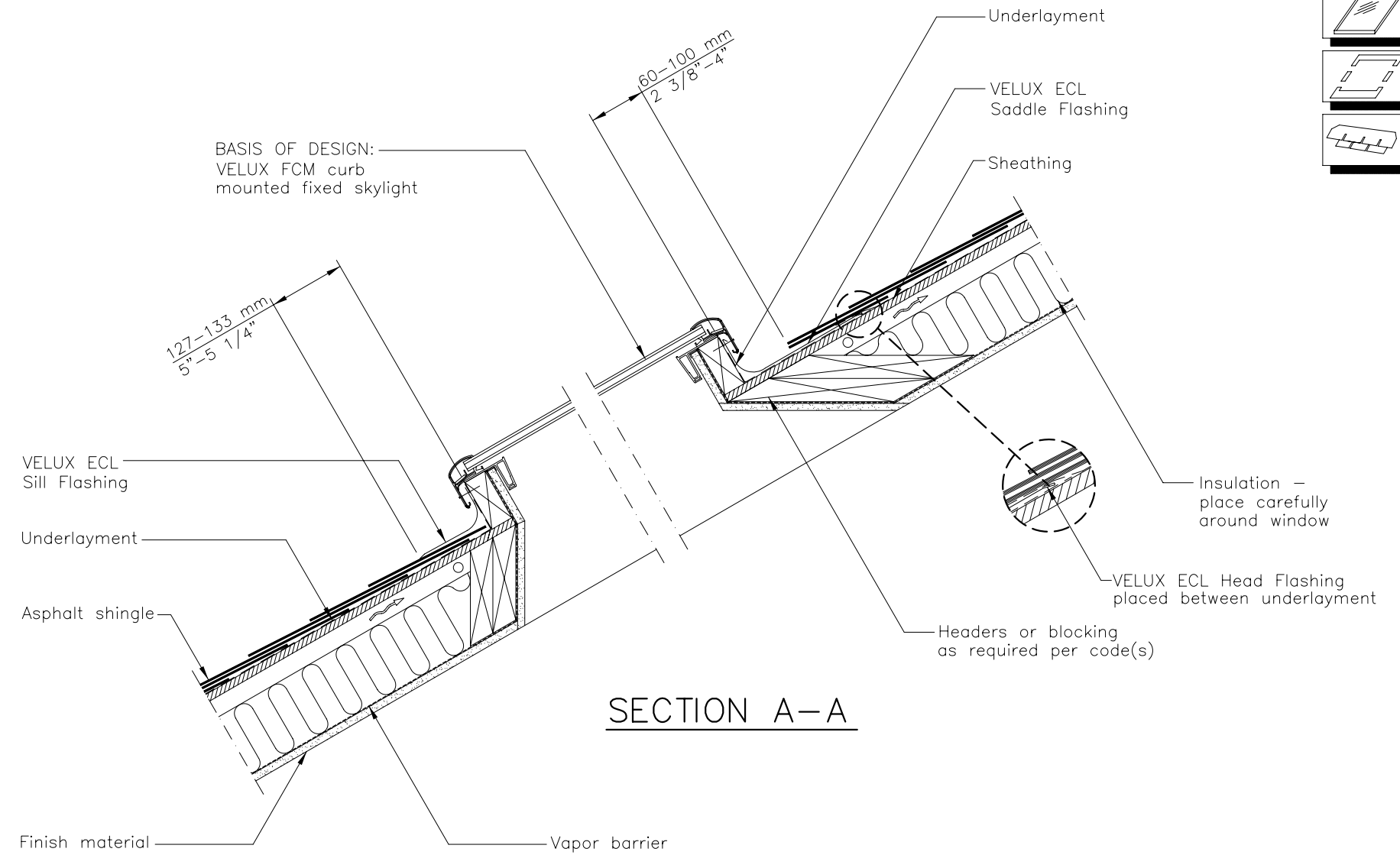

**SECTION A-A**

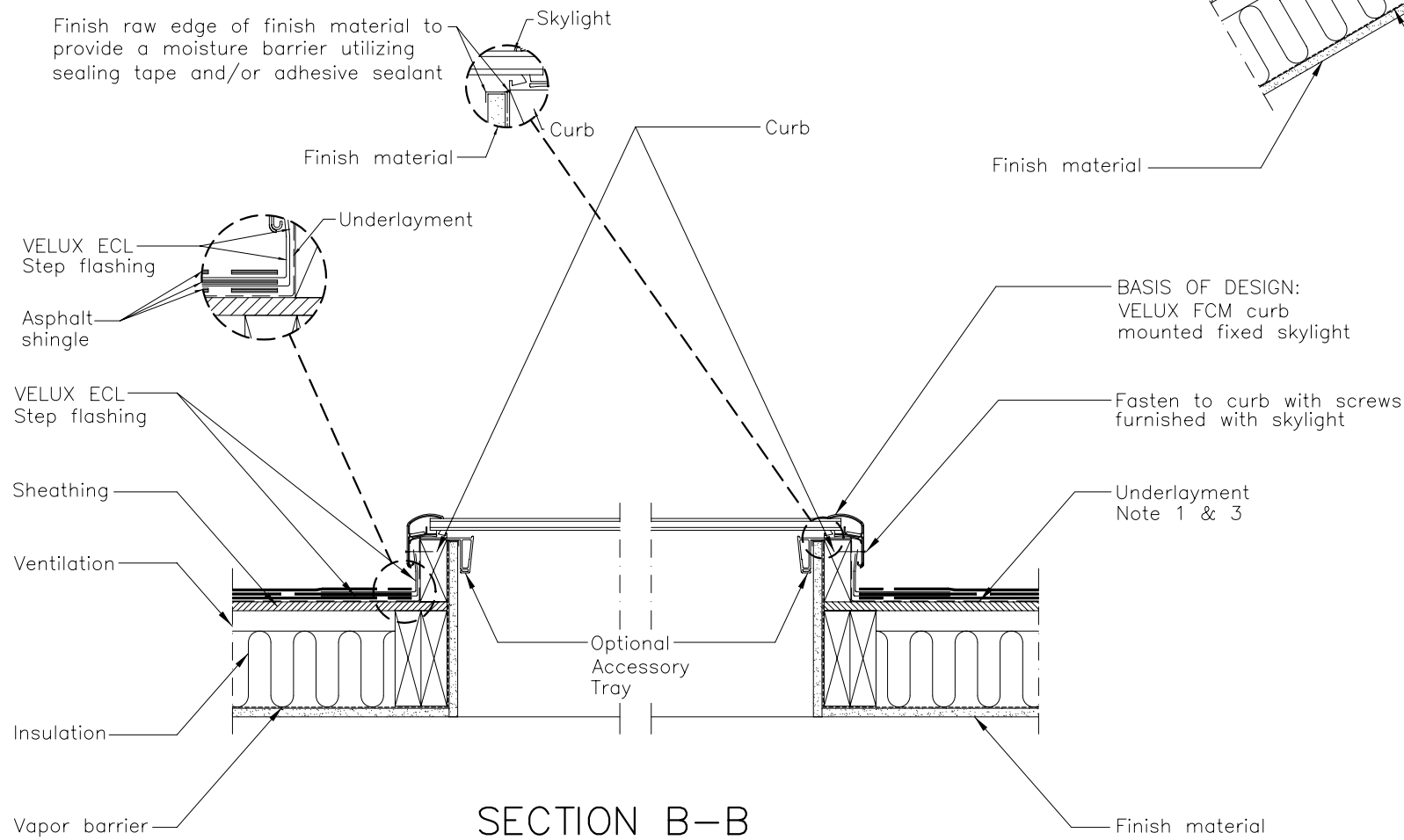

**SECTION B-B**

**GENERAL NOTES**

1. Underlayment to be folded up against all sides of curb.
2. Vapor barrier should be used to avoid moisture.
3. Wrap curb in underlayment. VELUX recommends use of VELUX type ZOZ 216 adhesive underlayment.

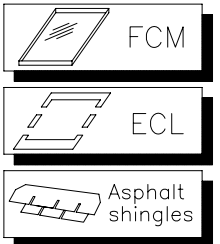

	VELUX 1418 Evans Pond Road Greenwood, SC 29649 1-800-88-VELUX www.VELUXUSA.com	Name Date
	Sky-Product Management	Drawn by Checked by Drawing No.
FCM-Residential/Commercial Roof Section (Cathedral Ceiling with Asphalt Shingles)		JDH Mar 10 WQ Mar 10 FCM-02-0310

This drawing is an instrument of service and is provided for informational use only.